

Standard Features on the Escape 5.0

- 11' Fiesta Awning
- 12,000 BTU Furnace
- 5.0 Cubic Foot Fridge
- Roof Maxx Fan
- 13" x 20" vent over upper bed
- 2 Burner Cooktop
- Counter Extension off Sink
- Sink Cover
- Power Rangehood with light
- 25' – 30 Amp Power Cord
- 45 Amp Converter / Battery Charger
- Oak Door Package
- Draw Down Pleated Shades with Valences
- 4" High Density Cushions
- Interior Shower
- 6 Gallon DSI Hot Water Tank
- 12 Volt Demand Water Pump
- 20 Gallon Fresh Tank
- 26 Gallon Grey Tank
- 19 Gallon Black Tank
- 120V Interior Outlets
- 12 Volt Interior Outlet
- 120 Volt Exterior Outlet
- 2 Exterior Lights (Driver and Passenger Side)
- Exterior Bubble Levels
- Large Factory Tinted Screened Windows
- Exterior Storage Compartments
- Dual Propane Package
- Locking Water Fill Hatch
- 15" Radial Tires (ST225-75R-15)
- Mud Flaps
- Full Size Spare Tire and Cover
- Group 27 Deep Cycle Battery
- Electric Brakes
- Rear Scissor Jacks
- Independent Power Landing Gear
- 3500lb Torsion Suspension
- Entry Step & Screen Door
- 20' Sewer Hose & Storage Compartment
- Smoke Detector
- Propane & Carbon Monoxide Detector
- Fire Extinguisher
- Vinyl Flooring
- Carpet Stairs and Top Bed
- Custom Wood Interior Finish
- Queen Size 7" Coil Mattress
- Mirror on Wardrobe
- Small Cubbies at Permanent Bed

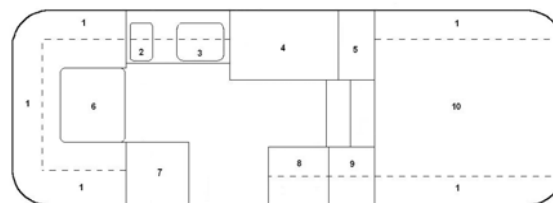

- | | |
|--|--|
| 1 Over Head Storage Cabinets | 6 U- Shaped Dinette (47" x 6'6") |
| 2 Sink | 7 2 Way 4.5 Cubic Foot Cornett Fridge |
| 3 Burner Cooktop | 8 Storage Pantry |
| 4 Bathroom with Sink & Shower (29" x 45" x 6'4") | 9 Exterior Storage |
| 5 Tall Wardrobe Closet | 10 Front to Back Queen Size Bed (60" x 6'6") |

Floor Plan For Escape 5.0

Total Length	19'-6"
Total Height	9'
Total Width	6'-8"
Interior Height	6'-4" - 7'
Bathroom	40" x 27" x 72"
Rear Bed	49" x 76"
Top Bed	60" x 76"
Dry Hitch Weight	480 lbs
Dry Axle Weight	2140 lbs
Total Weight	2620
King Pin Height	41" – 47"

Visit the Escape Forum at
www.escapeforum.org

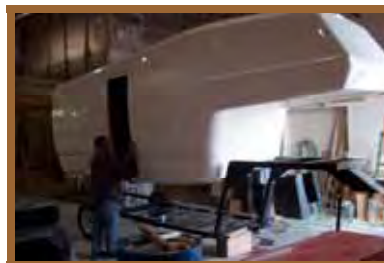

Escape Trailer Industries Ltd

The Escape 5.0



For More Information

www.escapetrailer.com

Please Contact Us At:

Tel 604-703-1650 / Fax 604-703-1651

43851 Industrial Way, Bldg B.

Chilliwack, BC, V2R-4L2

info@escapetrailer.com



Escape 5.0 Important Facts

Whether you are a seasoned RVer or just starting out, the Escape 5.0 comes prepared. Our commitment to quality and customer satisfaction makes the Escape one of the top rated RVs in North America. The US consumer group has placed the Escape 5.0 at the top of the list based on its coach, frame construction, tow ability and resale value. The Escape 5.0 comes with a full two year warranty and can be seen in many cities across Canada and the United States or stop in and see an Escape as it is being built in beautiful Chilliwack, British Columbia.

Two Piece Fiberglass Shell Construction

The Escape 5.0 represents high quality. The 100% molded fiberglass body is hand-laid in a two piece mold. Our fiberglass team bonds the upper and lower halves together before the shell is demolded and bolted to the frame. Anchor blocks are fiberglassed in strategic points inside the trailer to which interior walls and natural oak cabinetry are securely mounted creating a solid, structurally sound interior/exterior. This solid one-piece fiberglass shell is strong, durable, easy to clean and completely waterproof.

Lightweight & Aerodynamic Design

Many key features of the Escape make it lightweight and aerodynamic. The Escape 5.0 weighs approximately 2620 lbs (dry weight) keeping travel costs to a minimum. The Escape 5.0 targets the mid-size truck market as most trucks, including short-beds, with a V6 engine can tow the Escape.

The aerodynamic design of the Escape 5.0 includes a low center of gravity for better road stability, and decreased wind resistance when in tow. This combined with the rubber torsion suspension axle, which is used in all of our Escape models, not only reduces vibration while traveling but also provides independent suspension and is maintenance free. The 15" Goodyear tires (including the full size spare) are balanced before you pick up your trailer.

Amenities

Don't be fooled by its size. The Escape 5.0 comes standard with an easy and comfortable galley with a large 5.0 cubic foot fridge, a full interior shower, queen upper bunk, independent power landing gear and endless storage. The interior is professionally finished with natural oak cabinetry, large windows, high-grade linoleum flooring and a unique insulated vinyl headliner/wall covering.

